

# BUTNER ROAD CULVERT REPLACEMENT PROJECT

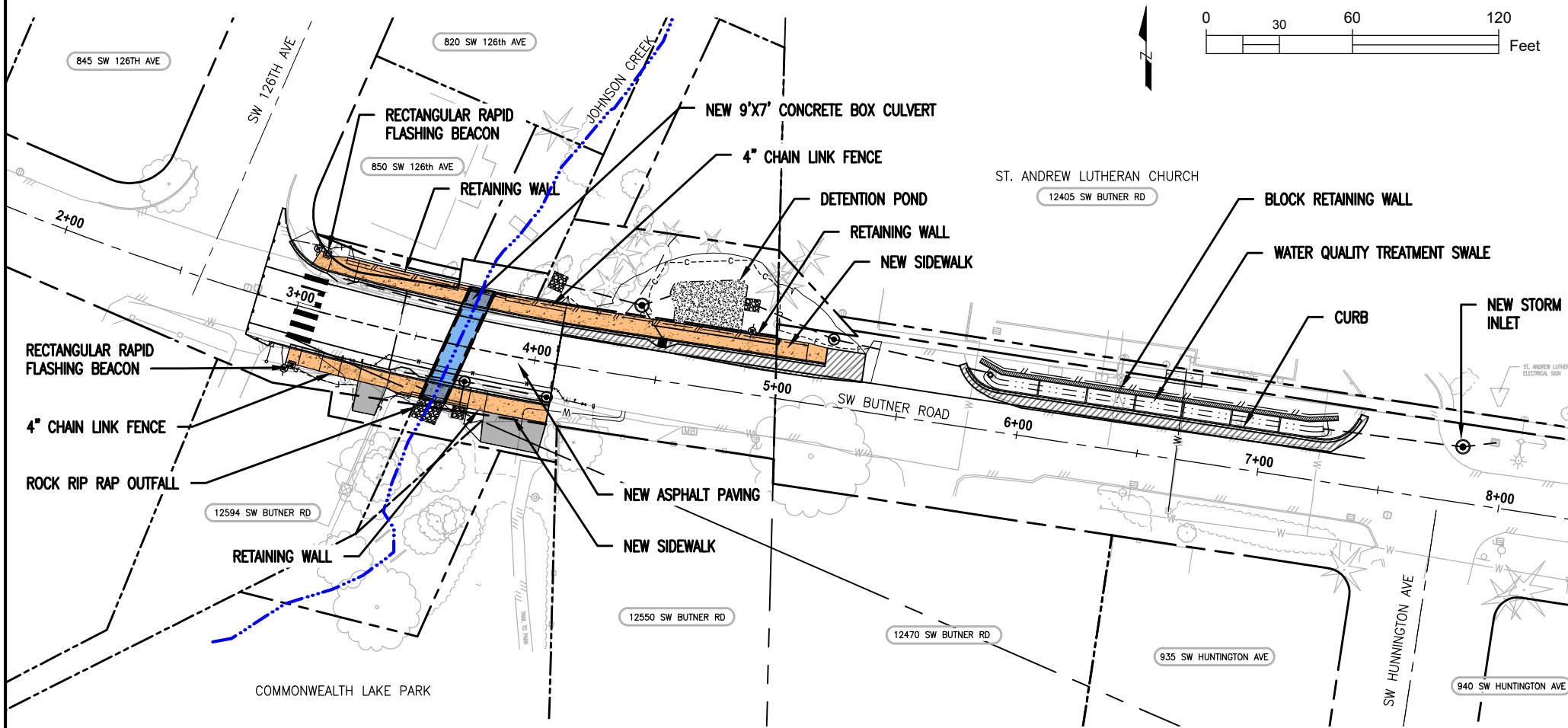

## LEGEND

- = EXISTING FEATURES
- = CUT LIMITS
- = FILL LIMITS
- = JOHNSON CREEK
- = BOX CULVERT
- = NEW DRIVEWAY
- = NEW SIDEWALK
- = CONCRETE
- = GRAVEL
- = DETENTION POND
- = ASPHALT WIDENING

## NOTES:

1. WORK INCLUDES RELOCATION OF TWD WATERLINE AND INSTALLATION OF NEW DRAINAGE SYSTEM WITHIN PROJECT LIMITS.
2. BIKE AND PEDESTRIAN ACCESS WILL BE MAINTAINED THROUGH PROJECT DURING CONSTRUCTION.
3. DURING CONSTRUCTION OF SOUTH HALF OF PROJECT, ACCESS TO PARK WILL BE FROM HUNTINGTON ROAD (BUTNER ACCESS CLOSED).

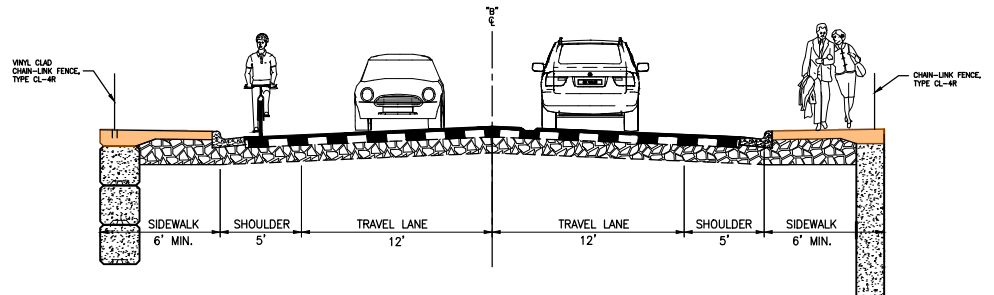

TYPICAL ROAD SECTION